

Committed to Superior Quality & Results



SHREE VINAYAKA HOMES

Presents

SP ROY BUNGALOWS

Caistar's Town, B.Deoghar
Jharkhand - 814112

**Mob- 9431165009
8210019059**

www.shreevinayakahomes.com

E-mail:- contact@shreevinayakahomes.com



ROY BUNGALOW

A place for happy
and safe home.



All specifications, design, layout images, conditions are only indicative and some of these can be changed at the discretion of the builder/ architect/ authority. These are purely conceptual and constitute no legal offerings. Applicants/ Allottee shall not have any right to raise objection in this regard.

The adobe of holy Land of
 "LORD SHIVA" known
 as Deogarh, spiritual land of god ,
 that comprises natural
 prosperity has natured a great
 fountain for peaceful
 living an oasis of sanctified
 tranquility brought to attract
 home seekers who are searching
 for an ultimate home,
 here at Deogarh.

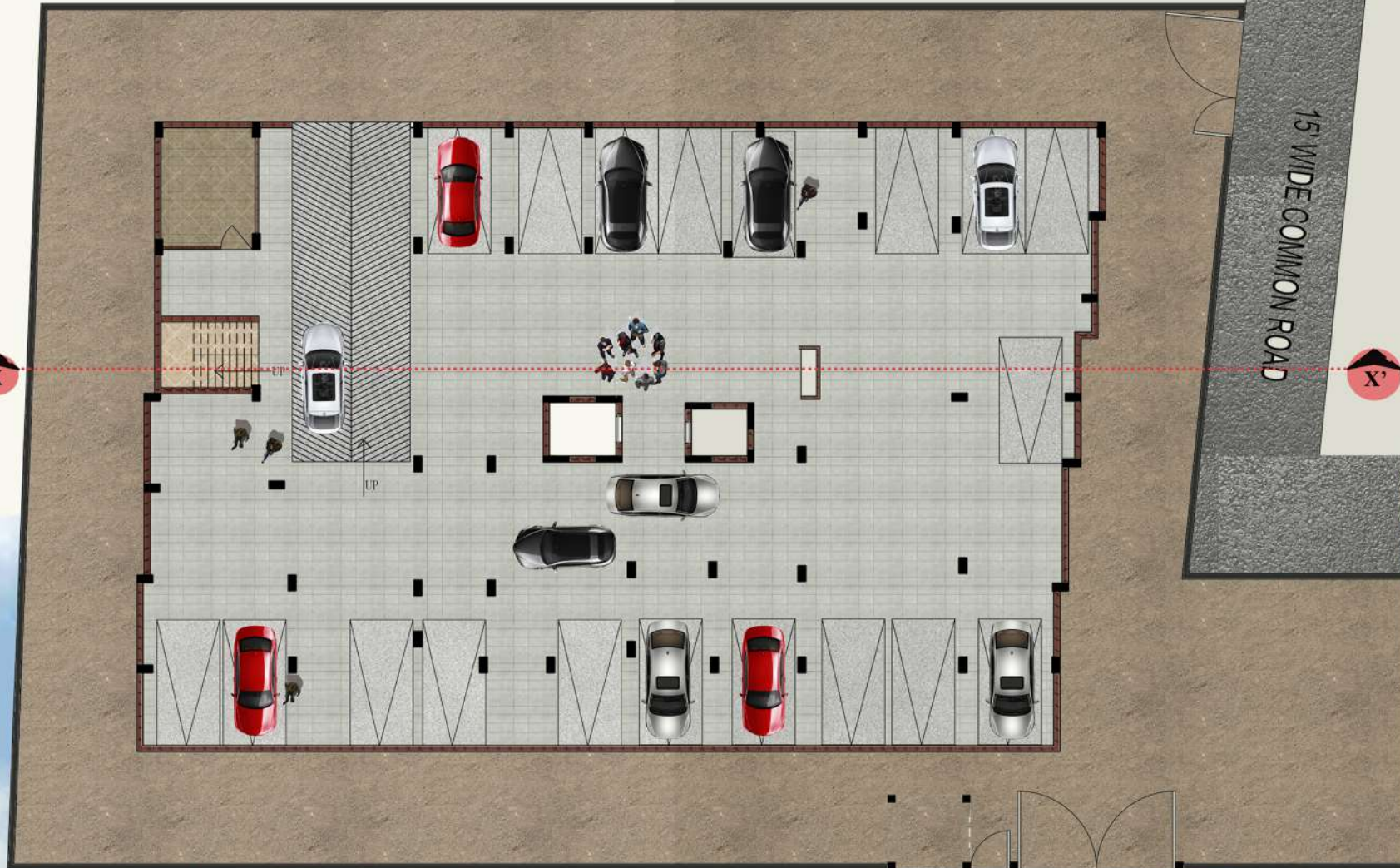

BASEMENT FLOOR PLAN



LONGITUDINAL SECTION XX'

All specifications, design, layout images, conditions are only indiative and somee of these can be changed at the discreation of the builder/ architect/ authority. These are purely conceptual and constitute no legal offerings. Applicants/ Allotee shall not have any right to raise objection in this regard.



All the amenities like Hospital
(Maa Lalita Hospital),
School (R.I.S Shool),
PVT. Bus Stand, Airport,
and a Baba Mandir
are all nearer to the Site.

STILT FLOOR PLAN

Key Plan



UNIT 1

Builtup Area - 1333.2 Sq.ft

Super Builtup - 1666.5 Sq.ft

- | | |
|-----------------------|-----------------|
| 1. Master Bedroom | 10' 0" X 12' 0" |
| 2. Bedroom - | 10' 0" X 10' 6" |
| 3. Toilet - | 8' 6" X 6' |
| 4. Drawing & Living - | 13' X 17' 6" |
| 5. Kitchen - | 14' 0" X 8' 8" |
| 6. Dining - | 13' 0" X 6' |
| 7. Balcony - | 5' Wide |



Kitchen



Drawing Room



Entry



UNIT 2

Builtup Area - 1085.6 Sq.ft
Super Builtup - 1357 Sq.ft

- | | |
|-----------------------|---------------|
| 1. Master Bedroom | 12'0" X 10'0" |
| 2. Bedroom - | 10'0" X 10'6" |
| 3. Toilet - | 5'0" X 7'7" |
| | 6'0" X 6'0" |
| 4. Drawing & Living - | 15'6" X 12'0" |
| 5. Kitchen - | 8'6" X 7'7" |
| 6. Dining - | 10'0" X 11'0" |
| 7. Balcony - | 5' Wide |
| 8. Mandir - | 4'6" X 6'6" |
| 9. Store - | 5' X 6'7" |



Key Plan



Bedroom



living space



Key Plan



UNIT 3

Builtup Area - 1325 Sq.ft
Super Builtup - 1656 Sq.ft

1. Master Bedroom 10'0" X 12'0"
2. Bedroom - 11'0" X 10'6"
3. Toilet - 5'0" X 7'0"
4. Drawing & Living - 11'0" X 17'0"
5. Kitchen - 10'0" X 7'7"
6. Dinning - 13'0" X 10'6"
7. Balcony - 5' Wide
8. Mandir - 4'0" X 5'6"
9. Store - 4'0" X 4'0"



All specifications, design, layout images, conditions are only indicative and some of these can be changed at the discretion of the builder/ architect/ authority. These are purely conceptual and constitute no legal offerings. Applicants/ Allottee shall not have any right to raise objection in this regard.



UNIT 4

Builtup Area - 1349 Sq.ft
Super Builtup - 1686 Sq.ft

- | | |
|-----------------------|---------------|
| 1. Master Bedroom | 11'0" X 10'0" |
| 2. Bedroom - | 10'0" X 11'6" |
| | 10'0" X 10'0" |
| 3. Toilet - | 5'0" X 7'6" |
| 4. Drawing & Living - | 15'0" X 18'0" |
| 5. Kitchen - | 11'6" X 7'7" |
| 6. Dinning - | 10'0" X 11'0" |
| 7. Balcony - | 5' Wide |

Key Plan



Bedroom



Dinning space

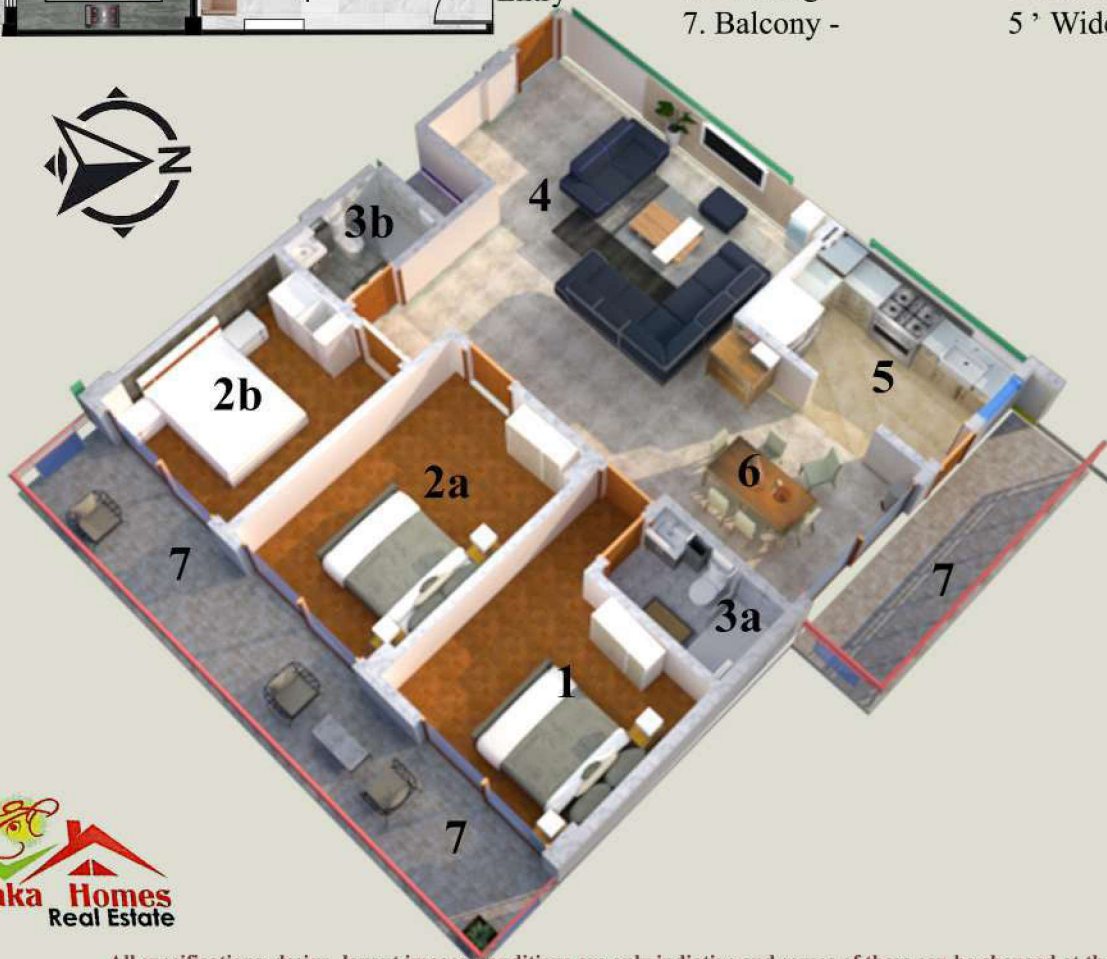

Key Plan



Bedroom



living space



UNIT 5

Builtup Area - 1294 Sq.ft
Super Builtup - 1617 Sq.ft

1. Master Bedroom 10'6" X 10'0"
2. Bedroom - 11'0" X 10'6"
10'0" X 13'7"
3. Toilet - 4'0" X 6'6"
4. Drawing & Living - 15'0" X 13'0"
5. Kitchen - 10'0" X 7'8"
6. Dinning - 10'0" X 11'0"
7. Balcony - 5' Wide
8. Mandir - 4'0" X 5'6"



Entry

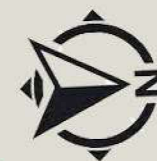

UNIT 6

Builtup Area - 1339 Sq.ft
Super Builtup - 1673 Sq.ft

- | | |
|-----------------------|---------------|
| 1. Master Bedroom | 11'0" X 11'0" |
| 2. Bedroom - | 11'0" X 11'0" |
| | 10'0" X 11'0" |
| 3. Toilet - | 5'0" X 7'6" |
| 4. Drawing & Living - | 15'0" X 15'6" |
| 5. Kitchen - | 7'6" X 12'0" |
| 6. Dinning - | 10'0" X 9'0" |
| 7. Balcony - | 5' Wide |



Washroom



Dinning space



Entry



BRIEF SPECIFICATION

Structure - RCC framed structure as per latest IS code consider stability in specified earthquake zone.

Brick Work - Load Bearing brick work with first class brick in cement mortar 1:6 and 1:4 in half work.

Pest Control - Structural shall be treated by chemical termite treatment

Internal Finishing - smooth plaster with the lamination of birla putty and painted by oil bound distemper.

Flooring - vitrified floor of recognized brand like Asian, Kajaria, Euro etc.

Kitchen and Staircase - Udaipur green or equivalent colourful marble at kitchen counter, in stairs steps and landing Stainless steel kitchen sink and colourful glazed tiles 2ft above counter.

Water Supply - Minimum 750 ltr water tank for each Flat.

External Finishes - Single layer plaster in facade and double layer plaster with groove in design. Colour by spectrum or equivalent paint.

Water Proofing - High class water proofing treatment with Tape Crete etc. shall be provided at every required place.

Doors - wooden frame shall be provided with flush door shutter and hardware.

TERMS & CONDITIONS

1. Cheques/drafts should be payable in the name of M/s SHREE VINAYAKA HOMES
2. Prices can be revised at any time at the sole direction of the co. without any notice. However, there will be no increase in sale price of the Unit booked.
3. All installments in the installment plan shall become payable within 15 days of demand.
4. Government charges i.e. applicable Stamp Duty, GST or any other Government charges will be extra.
5. GST @ 5%

Location Advantage:-

- Babadham Temple - 1Km
- Babadham Railway Station- 50M
- Jasidih Railway Station - 6Km
- Airport - 4Km
- AIIMS- 7Km
- Big Bazaar- 100M

PAYMENT SCHEDULE

1. At the time of booking - 20 % (price of flat)
2. At the time of roof casting of each floor (G+6) - 10% (60%)
3. At the time of starting brickwork and plastering - 10%
4. At the time of registry - 10% (less booking amount)

NOTE: a) Agreement must be done within one month from date of booking
b) Car parking will be extra
c) Other charges as DG set, electric transformer, and other legal charges will be extra.

LOCATION PLAN

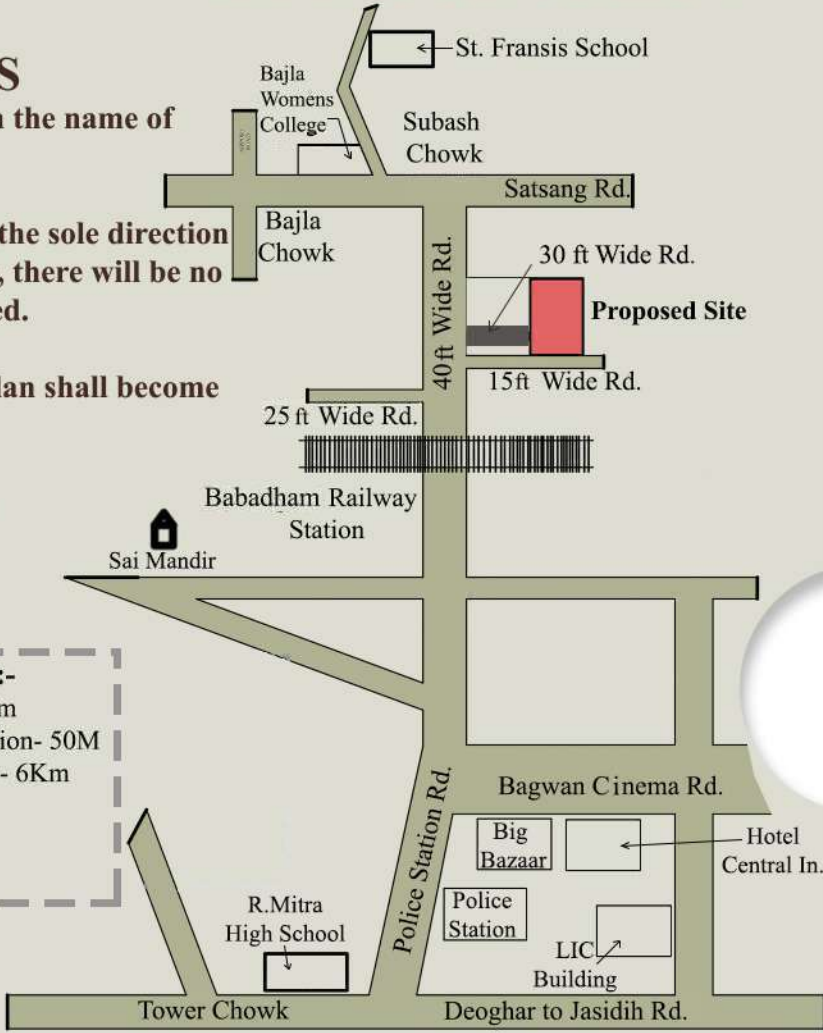



Shree Vinayaka Homes

Office - Old Phari No. 3, Castair Town, Deoghar, Jharkhand

Contact No :- +91-9431165009, 8210019059,

ARCHITECT

Arhta (Architect Harish Tripathi & Associates)

NEW DELHI Mob- 9811045628

ENGINEER

Shiv Construction & Consultant

Neeraj Singh-DEOGHAR Mob-9973798500

